

INSTALLATION INSTRUCTIONS

DESCRIPTION: Rear Rack Extension Kit
PART NUMBER: B16-F48A0-V0
MODEL: Kodiak 700, Grizzly 700



⚠ WARNING

Please read and understand these instructions completely before installation to avoid possible injury, or damage to the accessory or vehicle.

NOTICE:

Installation of this kit requires a torque wrench and should be performed by an authorized Yamaha dealer or other qualified mechanic.

WARRANTY INFORMATION:

Genuine Yamaha accessories are covered by a 1-year limited warranty against defects in material or workmanship. Labor for replacement of defective components is not covered. See your Yamaha dealer for a copy of the warranty statement.

DEALER OR INSTALLER:

These instructions contain important information for future reference and must be given to the customer.

PARTS LIST:

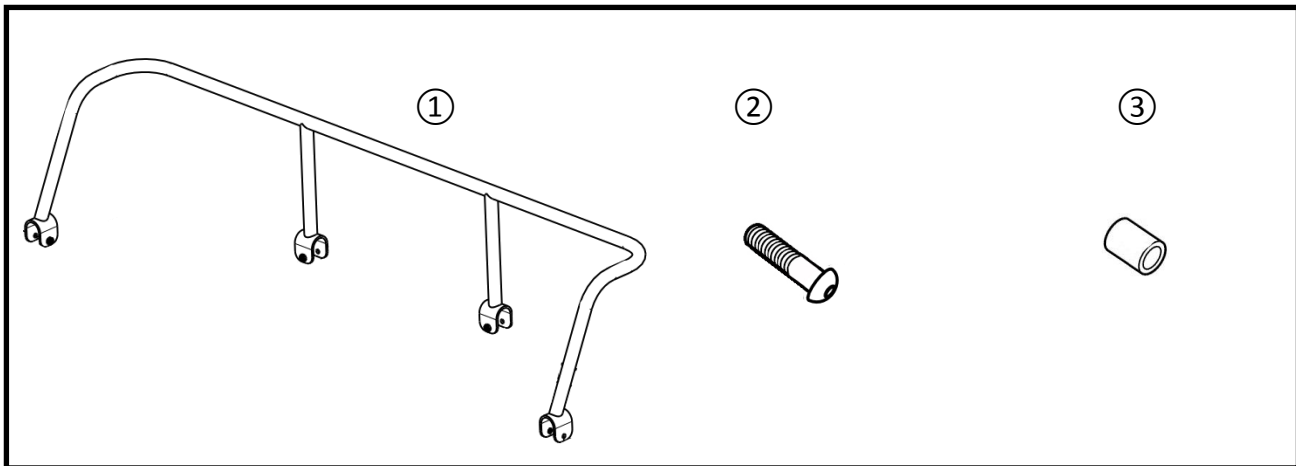

No.	Part Number	Description	Qty
*	B16-F48A0-V0	Rear Rack Extension Kit	--
①	*	Rear Rack Extension	1
②	*	M6X40mm Button Head Socket Cap Bolt	4
③	*	Spacer	4

* Part supplied with kit only and not available separately.

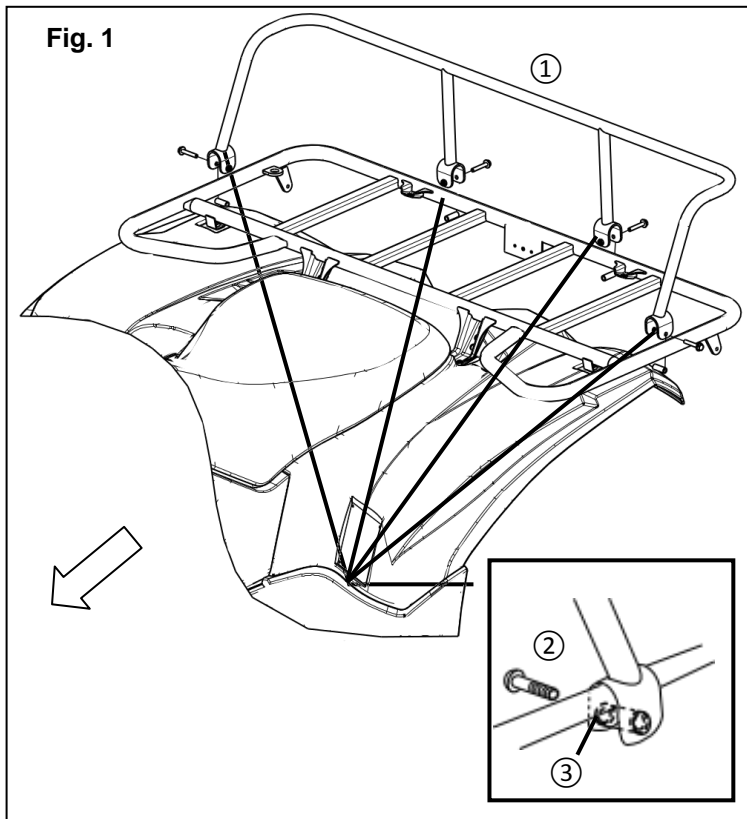

PREPARATION:

- Place vehicle on a secure and level surface.
- Set the parking brake.
- Clean all mounting surfaces before installation.

INSTALLATION:

1. Position the rack extension ① on the rack. The U-clamps on the rack extension fit over the rear rack tubes as shown in Fig. 1.
2. Insert a Spacer ③ and M6X40mm Button Head Socket Cap Bolt ② into the four clamp fittings.
3. Torque the button head bolts to 8Nm (.8m-kgf, 5.9 ft.-lbs) .

MAINTENANCE:

Check mount bolts and re-torque if necessary..

CARE AND CLEANING:

Wash with a mild soap and water solution using a soft cloth.

CUSTOMER SERVICE:

For further information see your Yamaha dealer.

ESTIMATED TIME TO INSTALL: 0.3 HRS.